



बड़ौदा यू.पी. बैंक
Baroda U. P. Bank

RO/FATEHP/05/P&E/2024-25/09

Date:- 03.05.2024

बड़ौदा यू पी बैंक
क्षेत्रीय कार्यालय फ़तेहपुर
2 A, गौतम नगर
आईटीआई रोड,
फ़तेहपुर-212601

(ONLY VENDORS EMPANELLED WITH BARODA U. P. BANK HEAD OFFICE,
GORAKHPUR CAN APPLY)

“SHORT TERM TENDER NOTICE FOR INTERIOR FURNISHING WORK, ELECTRICAL, UPS
& DATA CABELING WORKS AT BANDHWA CHAURAHA BRANCH DISTT. FATEHPUR”

निविदाएं जारी करना	04.05.2024 से 17.05.2024 तक
जमा करने की अंतिम तिथि	17.05.2024 अपराह्न 05.00 बजे तक
निविदा खुलने की तिथि	18.05.2024 समय प्रातः 11.30 बजे

(निविदाएं पैनल वेंडर या उनके अधिकृत प्रतिनिधियों की उपस्थिति में खोली जाएंगी)

निविदाएं बैंक की वेबसाइट www.barodaupbank.in/tender से डाउनलोड की जा सकती हैं या निम्नलिखित पते से प्राप्त की जा सकती हैं और दी गई तारीख तक जमा की जानी चाहिए (हमारे बैंक के पैनल में शामिल फर्निशिंग और इलेक्ट्रिकल विक्रेता आवेदन कर सकते हैं)

निविदा संग्रहण/प्रस्तुति का स्थान:

बड़ौदा यू पी बैंक
क्षेत्रीय कार्यालय फ़तेहपुर
2 A, गौतम नगर
आईटीआई रोड,
फ़तेहपुर-212601

Regional Office : 2A Gautam Nagar ITI Road Fatehpur-212601 (U.P.)
E-mail: pe.rofate@barodauprrb.co.in; Mo.05180-221213.





बड़ौदा यू.पी. बैंक
Baroda U. P. Bank

Terms and condition of tender:

- Rates should be quoted on the space provided in **annexure-I & II attached only**. No other sheet/form should be used for quoting rates.
- The competent authority (bank) does not bind themselves to accept the lowest or to give any reasons for its decision of acceptance or rejection of tenders.
- Incomplete in any respect or conditional tender shall liable to be rejected.
- Rates quoted only by bank's empanelled vendors will be consider/accepted.

Other conditions:

- The registration number of the firm along with **GST no.** allotted by the authorities must be submitted.
- **PAN NUMBER** of the firm allotted by the income tax authorities should be submitted (without which the vendor's bid would become invalid and shall be liable to reject)
- Conditional tenders shall not be accepted on any ground and shall be rejected straight.
- Any deviation of the conditions given by the purchaser will not be accepted and bid will be rejected without assigning any reasons.
- If any clarification is required the same should be obtained before submitting the bid.
- The entire document must be signed with the seal and attached as mark of acceptance of terms and condition.
- BUPB reserve the right to accept or reject any bid whole or in parts without assigning any reason thereof.
- Bank's decision will be final and no correspondence will be entertained in this regard.
- In case of delays in submission/non submission of bids ,Bank will not assume any responsibility.
- Bank may reject any or all quotations without assigning any reason.

Tender submission:

Submission of tenders in sealed envelope super scribing "**TENDER OF FURNISHING, ELECTRIC, DATA WORK OF BANDHWA CHAURAHA BRANCH**" addressed to "The Regional Manager Baroda U.P.Bank, Regional Office- Fatehpur, 2A Gautam Nagar ITI Road Fatehpur-212601", Complete in all respect latest by **5.00 PM dated- 17.05.2024** Tenders received after that shall not be entertained.

Tender must be submitted through hand to hand or through registered post.

Evaluation of tender:

Quoting incredibly low value of items with a view of subverting the tender process shall be rejected straight away.

Yours faithfully,

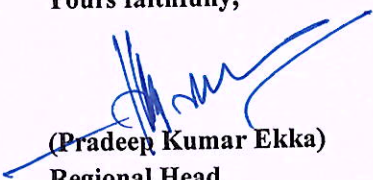
(Pradeep Kumar Ekka)
Regional Head
Fatehpur – Region

Regional Office : 2A Gautam Nagar ITI Road Fatehpur-212601 (U.P.)
E-mail: pe.rofate@barodauprrb.co.in; Mo.05180-221213.





बड़ौदा य.पी. बैंक
Baroda U. P. Bank

APPENDIX TO THE CONTRACT DOCUMENTS		
S.NO	Subject: Interior Funishing, Electrical, UPS & Data works for Baroda U.P. Bank at BANDHWA CHAURAHA Branch, Distt. FATEHPUR	
1	Defect liability period:	12 months from the date of virtual Completion of work.
2	Date of commencement:	3rd days after the contract is accepted by the contractor.
3	Date of completion:	3 (Three) weeks.
4	Liquidated damages:	1% of contract amount per week/day of delay Subject to maximum of 10% of contract amount for the works of less than 6-month completion period.
5	Period of honouring certificate:	15 days
6	Retention money:	5% of the bill value will be deducted as retention subject to maximum security deposit. The retention money so held shall be refunded after defects liability period of 12 months of full & final completion of job.
7	Release of Retention money:	After 14 days from defect liability period.

Regional Office : 2A Gautam Nagar ITI Road Fatehpur-212601 (U.P.)
E-mail: pe.rofate@barodauprrb.co.in; Mo.05180-221213.





बड़ौदा यू.पी. बैंक
Baroda U. P. Bank

(On letter head of firm)

To,

The Regional Manager,
Baroda U.P. Bank,
Regional Office,
2A Gautam Nagar
ITI Road
Fatehpur-212601

Dear Sir,

LETTER OF OFFER

Sub: Interior Furnishing, Electrical, UPS & Data works for Baroda U P Bank at Bandhwa Chauraha Branch, Distt. Fatehpur

With reference to the tender regarding the above work invited by you, we have to state as under.

We declare that before quoting the rates, we have visited all the sites and our rates are as per present sites condition. execution of the works at my /our tendered rates as per the Terms of Contract. In the event of this tender being accepted, I / We agree to enter in to and execute the necessary contract documents as required by you.

As required by you, I / We are returning herewith the documents (in single) duly signed by us at each page in token of our acceptance of the provisions in the documents.

We hereby offer to execute and complete the whole of the works strictly in accordance with the said conditions of contract, special conditions of contract, specifications and drawings to be provided by bank at the rates set out against each of the items of work in the schedule of quantities.

We have carefully read and clearly understood the conditions of contracts, special conditions of contract, and specifications. We agree to complete the work at the rate / rates quoted by me / us in the schedule of quantities and within the specified time from the date of work order awarding the work to us.

We understand the work is to be completed within scheduled time period.

Our rates are firm, include and cover all cost, expenses, liabilities of every description and all risk of every kind to be taken in execution and handing over the work to the Bank. The GST, Service Tax, Sales Tax (State & Central), works contract tax, octroi, duties, municipal tax, general tax and any other taxes applicable and prevailing from time to time on such item for which the same are leviable and the rates quoted by us are inclusive of the same.

Thanking You,

Yours faithfully,

Name :
Address:
Mobile No. :

Regional Office : 2A Gautam Nagar ITI Road Fatehpur-212601 (U.P.)
E-mail: pe.rofate@barodauprrb.co.in;Mo.05180-221213.





बड़ौदा य.पी. बैंक
Baroda U. P. Bank

General Information

Name of the vendor.....

Address for correspondence.....

.....

Permanent Address.....

.....

.....

Telephone No/Mobile No.....

.....

PAN NO.....

GST No.....

Email Id.....

Regional Office : 2A Gautam Nagar ITI Road Fatehpur-212601 (U.P.)
E-mail: pe.rofate@barodauprrb.co.in;Mo.05180-221213.





बड़ौदा य.पी. बैंक
Baroda U. P. Bank

PROJECT - SPECIFICATION FOR FURNITURE,ELECTRICAL & DATA CABLING WORKS.		
BANK - BARODA U.P. BANK		
BRANCH- BANDHWA CHAURAHA		
REGIONAL OFFICE- FATEHPUR		
*ALL WORKS TO BE DONE AS PER TENDER CONDITIONS.		
A	FURNITURE ITEMS	BRAND
1	LAMINATES (IS-2046) / VENEER	GREEN LAM / CENTURY / ARCHID / SAMRAT / FORMICA / SUNDEK OR APPROVED EQUIVALENT
2	COMMERCIAL PLY (IS-303) / WATERPROOF PLY (IS-710) / BLOCK BOARD (IS-1659) / FLUSH DOOR (IS- 2202)	ARCHID/ SAMRAT / CENTURY / EURO / GREEN OR APPROVED EQUIVALENT BY EIC.
3	ADHESIVES	FEVICOL / BLUECOAT/ VAMICOAL
4	LOCKS	GODREJ
a	MULTIPURPOSE GROUP LOCK	E-MPL1-22 / E-MPL1C-22 (EBCO)
b	NIGHT LATCH	8812 (GODREJ)
c	CYLINDRICAL LOCK (SS MATT FINISH)	3792-WITH KEY AND 3786-KEYLESS (GODREJ) / C120SS (EUROPA)
d	MORTISE DEAD LOCK (TWO WAY)	8815(GODREJ)
e	MORTISE LOCK WITH DOOR HANDLE	MATIZ 8083(GODREJ)
5	DRAWER CHANNELS	GODREJ/ HATTICH/ OZONE
a	TELESCOPIC CHANNELS (ZINK PLATED)	STDS35(I)35/ STDS25(I)35/ STDS50(I)35/ STDS60(I)35 (EBCO)
b	BOTTOM CHANNELS (POWDER COATED)	BMDS 35/ BMDS 37/ BMDS 55/ BMDS 60 (EBCO)
6	GENERAL HARDWARE	SS MATT FINISH
a	DOOR STOPPER	I) BLACK/IVORY/BROWN/SILVER COLOR POWDER COATED DS1 (EBCO) II) SPRING TYPE BLACK/BROWN/IVORY COLOR POWDER COATED (ECGL'S STERLING)
b	HINGES	I) 3"/4"/5"/6" 1.8MM TH. SS MATT FINISH (SUZU) II) 75X12X19 1.2 MM TH. SS MATT FINISH FOR STORAGE (SUZU) III) AUTO CLOSE HINGES – SLIP ON HINGE- EURO / CLICK ON HINGE-I (EBCO) FOR STORAGE
c	HANDLES 'D' OR 'C' TYPE	1) 3"/4"/6"10MM DIA SS 202 MATT FINISH (ANJALI)
d	TOWER BOLT	3"/4"/6"/8" BRASS EXTRUDED SS MATT FINISH (OSWAL)
e	SLIDING CHANNEL	EBCO MAKE APPROVED BY ARCHITEC/BANK.
7	FLOOR SPRING	
a	60 KG	7477 (GODREJ) / M-74 (HARDWYN)
b	80 KG	8293 (GODREJ) / M-74 (HARDWYN)
c	100 KG	8294 (GODREJ) / M-76 (HARDWYN)
8	DOOR CLOSER	
a	60 KG	DOUBLE SPEED 8292-SILVER, 7325- GOLDEN (GODREJ) / SCORPIO (HARDWYN)
b	FIRE RATED 60 KG	1938 (GODREJ) / TRITON (HARDWYN)

Regional Office : 2A Gautam Nagar ITI Road Fatehpur-212601 (U.P.)
E-mail: pe.rofate@barodauprrb.co.in;Mo.05180-221213.





9	PATCH FITTINGS FOR DOOR AND FIXED GLASS PARTITION (TOP/BOTTOM PATCH, PIVOT, PATCH LOCK, L ARM, L CONNECT, CONNECTOR, FLOOR SPRING, HANDLE, PLASTIC PROFILE)	GODREJ / XL C SERIES(DORMA) / OPF SERIES (OZONE) OR APPROVED EQUIVALENT
10	GLASS / MIRRORS	SAINT GOBAIN / MODI
11	ALUMINUM SECTION	JINDAL / INDAL / BANCO
12	WINDOW BLINDS	VISTA / AEROLUX/HUNTER DUGLUS / MAC
13	POLISH / PAINT	ASIAN PAINTS / BERGER / NEROLAC
14	PARTICLE BOARDS	NOVAPAN / DECO BOARD
15	COMPUTER ACCESSORIES	
a	CPU HANGER/ SHELF	SIDE MOUNTED IS CPU HL SM (INNOFIT) / CPUSM(EBCO) , 4/2-SMCS (ZIPCO)
b	CABLE MANAGER (60MM)	I) METAL - CO60ZN1(EBCO) II) PVC - CO 60 (EBCO) BLACK/IVORY/GREY COLOR
16	ACP PANEL	TIMEX / ALU DECOR / EURO OR APPROVED EQUIVALENT
17	WHITE FILM FOR GLASS	CRYSTAL / SONA MAKE VINYL FROSTED FILM
18	PAINTS	ICI, ASIAN,DULUX, BERGER, NEROLAC, JOHNSON & NICOLSAN
a	ANTI CORROSIVE PAINT	TIKITAR, FINCOAT
b	RED OXIDE	ASIAN, DULUX,NEROLAC
c	POLISH	ASIAN MELAMINE
d	EXTERIOR PAINTS	DULUX WEATHERSHIELD OR APP. EQUIVALENT
e	ENAMEL PAINT	ICI, DULUX, ASIAN, NEROLAC
19	FALSE CEILING	
a	GYPSUM BOARD	GYPROC (SAINT GOBAIN)
b	FRAMING WITH COMPLETE SYSTEM	GYP STEEL ULTRA (SAINT GOBAIN), RAMCO FUJI
c	HILUX BOARDS	RAMCO OR APPROVED EQUIVALENT
d	MINERAL FIBRE TILES CEILING WITH COMPLETE SYSTEM	ARMSTRONG/SAINT GOBAIN/USG
APPROVE MAKE LIST FOR ELECTRICAL WORK		
1	PVC rigid conduits & Accessories:	1.5 mm thick (MMS) ISI and FIA approved - Precision / Vraj / Nihir / BLP / PFI / Anchor / Polycab make. (Only white coloured pipes FRLS type to be used.).
2	L.T. Cables:	Havells / KEI / Polycab / R. R. Kable / Finolex.
3	Wires (FRLS):	Havells / KEI / Polycab / R. R. Kable / Finolex.
4	Main Distribution Boards:	MDS Legrand (Lexic) / Hager / Crabtree XPOA / Schneider (Eazy 9) / L & T EXORA / C & S Wintrip / Siemens Bitaguard.
5	ELCB / RCCB / Miniature Circuit Breaker:	MDS Legrand (Lexic) / Hager / Crabtree XPOA / Schneider (Eazy 9) / L & T EXORA / C & S Wintrip / Siemens Bitaguard.
6	Switch gears:	MDS Legrand (Lexic) / Hager / Crabtree XPOA / Schneider (Eazy 9) / L & T EXORA / C & S Wintrip / Siemens Bitaguard.

Regional Office : 2A Gautam Nagar ITI Road Fatehpur-212601 (U.P.)
E-mail: pe.rofate@barodauprb.co.in;Mo.05180-221213.





बड़ौदा यू.पी. बैंक
Baroda U. P. Bank

7	Change Over Switch:	HPL Socomac/ Havells / L & T / Hager.
8	Domestic fittings:	
a	All Switching Modular Accessories.	MK Wrapped Wround Plus / Schneider Livia / L & T entis / Crabtree Verona / Salzer Elite / Legrand Myris / C & S Divino / SSK Ace.
b	Holdes / ceiling roses	Anchor or equivalent approved make.
c	Adhesive Tape	Bhor (Steel Grip) or approved .
9	10 - 30 A Polycarbonate Socket & Top:	MDS Legrand (Lexic) / Hager / Crabtree XPOA / Schneider (Eazy 9) / L & T EXORA / C & S Wintrip / Siemens Bitaguard.
10	Telephone Wires / Cable:	Finolex / R. R. Kable / Havells / L & T / Polycab.
11	Telephone tag block:	Krone make.
12	Cable Lugs:	Dowell / Lotus / Jainson / 3 D.
13	Cable gland Single / Double Compression:	HMI / Comet / 3D.
14	Ammeter / Voltmeter:	AE / HPL / MECO/ Enercon make.
15	Selector switches:	L & T salzer / Kaycee make.
16	Indicator lamps:	LED type Teknic / Precifine/ Binay.
17	Connector strips:	Wago / Elmex make.
18	Lighting Fixtures :	Wipro / Philips / GE / Crompton. only
19	Exhaust fan (Light duty):	Khaitan / Crompton / Havells.
20	Ceiling Fan (5 star rated):	Crompton (High Breeze Plus) / Havells.
21	Wall mounted Fan (5 star rated):	Crompton (High Flow Wave) / Havells.
22	Data Cable - I / O Unit:	D - Link / Digi Link.

Regional Office : 2A Gautam Nagar ITI Road Fatehpur-212601 (U.P.)
E-mail: pe.rofate@barodauprb.co.in;Mo.05180-221213.



Annaxure-I

Schedule of Quantity/Tender of Furnishing work of Baroda U.P. Bank Bandhwa Chauraha Branch Distt. & R.O.Fatehpur

S.No.	Item's of work	Qty	Unit	Rate	Amount(Rs.)
1	Low Height Counter				
	2'-6" wide made out of 19mm thick board with drawer unit and front side 12mm thick Etching Glass Supported with Teak wood or Aluminum member With 1.0 mm thick laminate on the top & Drawer unit shall be provided on one side while with space for CPU by its side pull out tray on slide shall be provided on each counter for keeping keyboard. all the exposed edges shall have 6 mm. TW lapping duly polished inside surface shall be enamel painted two coats over primer coats. It shall be locks & handles etc. rovision for wire management shall be made. Complete work as per branch Manager/ Architect Satisfaction.	7	RFT		
2	Cash Counter				
	P/F of Bank Cash counter in partition two level cash counter 5'-0" long (with 3'-10" and 2'-6" height) counter for customer to be 1'-6" wide and counter to be 3'-0" wide with drawer unit made out of 19mm thick board with 1.0 mm thick laminate on top and front and other internal surface to be painted/polished complete as per item no.1	4.5	RFT		
3	Cash Cabin Partition				
	P/F of Cash cabin partition front-over the counter supported on 2"x1-1/2" sal wood frame work cover with 8.0 mm thk. Etching glass supported of 1"x1/2" beading with book window in size 5"x6" center of the counter with 2"x2" spacing Aluminium grill will be fixed in front of partition Side partition supported 2"x1-1/2" sal wood well seasoned structure with a cost of antitermite treatment up to 3'-0" height framing of inside area with 2"x1-1/2" sal wood section 2'-0" c/c horizontal and vertical with both side 6mm thick ply & 1.0mm thick laminates both side. The upper portion up to 4'-0" height shall be of 2-1/2"x2"x2-1/2" Aluminum grill will be fixed complete with all accessories and labour.	108	SQT		
4	Branch Manager/ Advance dept. Cabin				
	P/F of Low Ht. (4'-6" High) Partly glazed Laminated Portion in Branch Manager/ Advance dept. Cabin the Under Framing shall be of 2"x2" sal wood (Anti termite Treatment) for under framing at a max. distance 2'-0" in each direction. 6 mm th. Waterproof Ply shall be fixed on two side & 1.0mm thick laminated shall be pasted over its with chemical adhesive Provision shall be made molding melamine Polished shall be fixed Wherever necessary bottom 4" width shall have 5mm th. Plane glass	180	SQT		

Vendor Seal and Signature



Schedule of Quantity/Tender of Furnishing work of Baroda U.P. Bank Bandhwa Chauraha Branch Distt. & R.O.Fatehpur

S.No.	Item's of work	Qty	Unit	Rate	Amount(Rs.)
5	UPS Space				
	P/F of Low Ht.(4'-6" High) Laminated Portion for UPS Space the Under Framing shall be of 2"x2"sal wood (Anti termite Treatment) for under frame in at a max. distance 2'-0" in each direction. 6 mm th. Waterproof Ply shall be fixed on two side & 1.0mm thick laminated shall be pasted over its with Chemical adhesive	0	SQT		
6	Low Height Partition/Wicket				
	P/F Low height partition/Wicket gate all specification as item No.4 .	14	SQT		
7	Aluminum Entrance Door				
	Providing and fixing in position double leaf powder coated Aluminum Entrance door made of 14 guage thick sheet. All member shall be of 4"x1-3/4"section and bottom rail shall be of 5"x1-3/4"section with 6mm thick clear sheet glass including 4"dia 2 Nos. handles 10"long 2 Nos, Tower bolts, floor spring 2 Nos. lock etc. complete.	102	SQT		
8	P/F of Godrej Night Latch.	1	NO		
9	P/F of Godrej Mortic Lock	2	NOS		
10	P/F of Door Closer I.S.I mark	2	NOS		
11	Writing Desk				
	Providing and fixing Writing desk in position box type Wooden writing in public space of approximate size 4'-0"x 2'-0" made out of 19mm thick good approved quality ply with 6" to 9" wide pigeon hole type compartments in the front facade boxing for keeping pay-in-ship, book literature etc. These Writing table's must have laminates 1.0mm thick on top writing desk and two sides of the Boxes. With beading, lipping, molding and painting /polishing complete.	1	NOS		
12	Suggestion Box	1	NOS		
13	Check Drop Box	1	NOS		
14	Aluminum Grill				
	Providing and fixing Aluminum grill in cash cabin Grill Size 2-1/2"x2"x2-1/2" will be fixed complete with all accessories & labour.	45	SQT		
15	Notice Boards				
	Providing and fixing in position Notice boards of approximate size 3'-0"x2'-0"and 6" deep made out of 19mm thick ply with fully glazed shutter in front and soft board with felt cloth lining at the back inclusive of good approved quality lock to this shutter, hinges, fixtures, handle etc. and front laminate /painted complete as directed by bank architect.	1	NOS		

Vendor Seal and Signature



Schedule of Quantity/Tender of Furnishing work of Baroda U.P. Bank Bandhwa Chauraha Branch Distt. & R.O.Fatehpur

S.No.	Item's of work	Qty	Unit	Rate	Amount(Rs.)
16	Side Units				
	Providing and placing in position side units made out of 19mm board with 1.0mm laminate with sliding hinged shutters (made out of 12mm thick ply with 1.0mm thick laminate on it) complete with handles etc. size 4'-0"x1'-6"x2'-6"	2	NOS		
17	Column/Wall Paneling				
	Providing and fixing Column/Wall paneling (8'-6" Height) paneling all specification as per item no.4.	42	SQT		
18	Filling Cabinet				
	Providing & fixing wooden Filling Cabinet 1'-6" deep to be fixed on the wall frame made out of 19mm thick commercial ply with siding hinge shutters made out of 12mm thick ply with 1.0mm laminate on the front & side other internal surface to be painted as complete with handle, lock, wall catches etc.	102	SQT		
19	Branch Manager Table				
	P/F in Position Branch Manager Table (Size-6'-0" x3'-0") made out of 19mm th. water proof board with 1.0 mm th. Laminated on all exposed surface (others external surface shall be painted with two coats of enamel paint over one coat of primer) It shall have one unit on one side while provision to be made for pull out tray on slides. the table to be finished in TW/ HW lapping & godrej lock, handles, footrest, latches all complete.	1	NOS		
20	Officer Table				
	P/F in Position Officer Table (Size-5'-0" x2'-6") made out of 19mm th. water proof board with 1.0 mm th. Laminated on all exposed surface (others external surface shall be painted with two coats of enamel paint over one coat of primer) It shall have one unit on one side while.	1	NOS		
GRAND TOTAL (in digit) Rs.					*
GRAND TOTAL (in words) Rs. _____ Lakh _____ Thousand _____ Hundred Only*					

(Note: *GST Extra as applicable in above rates)

Empaneled Architech/Prepared By

Vision Arch Sh. 2/51, D-7-M, Prince Cyber
Café Building, Near Meerapur Basahi Crossing,
Varanasi

Vendor Seal and Signature



Annaxure-II

Schedule of Quantity/Tender of Electrrical & Data Cabling work of Baroda U.P. Bank Bandhwa Chauraha Branch Distt. & R.O. Fatehpur

S.No.	Item's of work	Qty	Unit	Rate	Amount(Rs.)
1	S/F of plug socket board				
	S/F of plug socket board consisting of 3 plug 5 Amp, three pin, three switch and one indicator with 1.5 sq mm separate circuit wiring for computer.	8	NOS		
2	S/F of UPS earthing				
	S/F of UPS earthing-S/burying of Dual pipe technology (Pipe in Pipe) earthingelectrode having GI 80mm O/D pipe with 25 micron coating, 3metres long. The space between two pipes to be filled with Highly conductive & Non corrosive chemical compound. The vacant space between pipe & hole shall also be filled with Compound all around. The job also includes S/F of GI strip clamp with two holes (with SS/GI bolts & nuts) on the electrode& taking two earthing leads of 4mm dia copper wire (Assumed length of 10m -beyond 10m to be paid extra)upto Main panel complete in all respects with guaranteed E/N voltage of less than 2 volts and resistance less tahn 1ohms. The 4mm dia Cu. earth wire shall be terminated on a separate 6way earthlink. The connections for Panel earthing& earth bus in the panle should be taken from this earthlink	2	NOS		
3	S/W 10 Amp, Plug point				
	S/W 10 Amp, Plug point with 2.5 sq mm copper wire in counter with continuous earthing wire complete in all respect with modular switches /socket.	6	NOS		
4	S/F of LED				
	S/F of LED Batten 20 watt light Fitting with 1.5 sq mm wiring complete in all respect including modular switches	12	NOS		
5	S/F of 20 Amp plug point				
	S/F of 20 Amp plug point with 2.5 sq mm wiring including modular switches /socket with continuous circuit wiring.	6	NOS		
6	S/F of wall mounted fans				
	Providing & Fixing of wall mounted fans (400dia) complete with 1.5 Sq mm wiring and modular switches. The work to include making hole in wall	5	NOS		
7	S/F of cabin fans				
	Supplying and Fixing of cabin fans (400Dia) in cash cabin/ in 1.5 sq mm wiring and modular switches.	1	NOS		
8	S/F of circuit wiring for computer				
	Supplying and Fixing of circuit wiring for computer in 2.5 sq mm copper wire.	10	NOS		
9	S/F of wiring for lights and fans				
	Supplying and Fixing of wiring for lights and fans 1.5 sq mm copper wire complete in all respect.	12	NOS		
10	S/F of exhaust fan in toilet/hall				
	Supplying and Fixing of exhaust fan in toilet/hall 15 1nch dia 1.5 sq mm wiring and modular switches.	2	NOS		

Seal and Signature of Vendor



Schedule of Quantity/Tender of Electrical & Data Cabling work of Baroda U.P. Bank Bandhwa Chauraha Branch Distt. & R.O. Fatehpur

S.No.	Item's of work	Qty	Unit	Rate	Amount(Rs.)
11	S/F of ceiling fan				
	S/F of ceiling fan (1200 dia) with hooks in rooms with adding rod of suitable length wherever necessary including 1.5 sq mm wiring and modular switches and regulator	5	NOS		
12	S/F of 12 way SPN DB				
	S/F of 12 way SPN DB double door with 10 No SP MCB and 1 no DPMCB 40 AMP for computer	2	NOS		
13	Sub main wiring of UPS				
	Sub main wiring of UPS input and UPS output power supply with 2 no 6 sq mm No. 4 sq mm copper flexible wire in PVC conduit pipe. (payment as/actual length on site)	35	MTR		
14	S/F on board 3 no KIT KAT cut out				
	Supply and fixing on board 3 no KIT KAT cut out 200 amp with neutral link on board	1	JOB		
15	S/F Changeover				
	S/F 63 Amp Changeover	1	NOS		
16	S/F Main Switch				
	S/F 63 Amp Main Switch	1	NOS		
LAN Cabling					
17	S/D CAT 6 Cable				
	Supplying and drawing CAT 6 PVC insulated and Sheathed LAN cable through PVC conduit including testing, commissioning etc.as required.	180	MTR		
18	S/F of RJ modem Jack				
	Supply and fixing of RJ modem Jack for computer including making connection, soldering etc	8	NOS		
19	S/F of Patch Card				
	Supply and Fixing of Patch Card with CAT 6 Jack	8	NOS		
GRAND TOTAL (in digit) Rs.					*
GRAND TOTAL (in words) Rs. _____ Lakh _____ Thousand _____ Hundred Only*					

(Note: *GST Extra as applicable in above rates)

Empaneled Architech/Prepared By

Vision Arch Sh. 2/51, D-7-M, Prince Cyber Café
Building, Near Meerapur Basahi Crossing,
Varanasi

Seal and Signature of Vendor



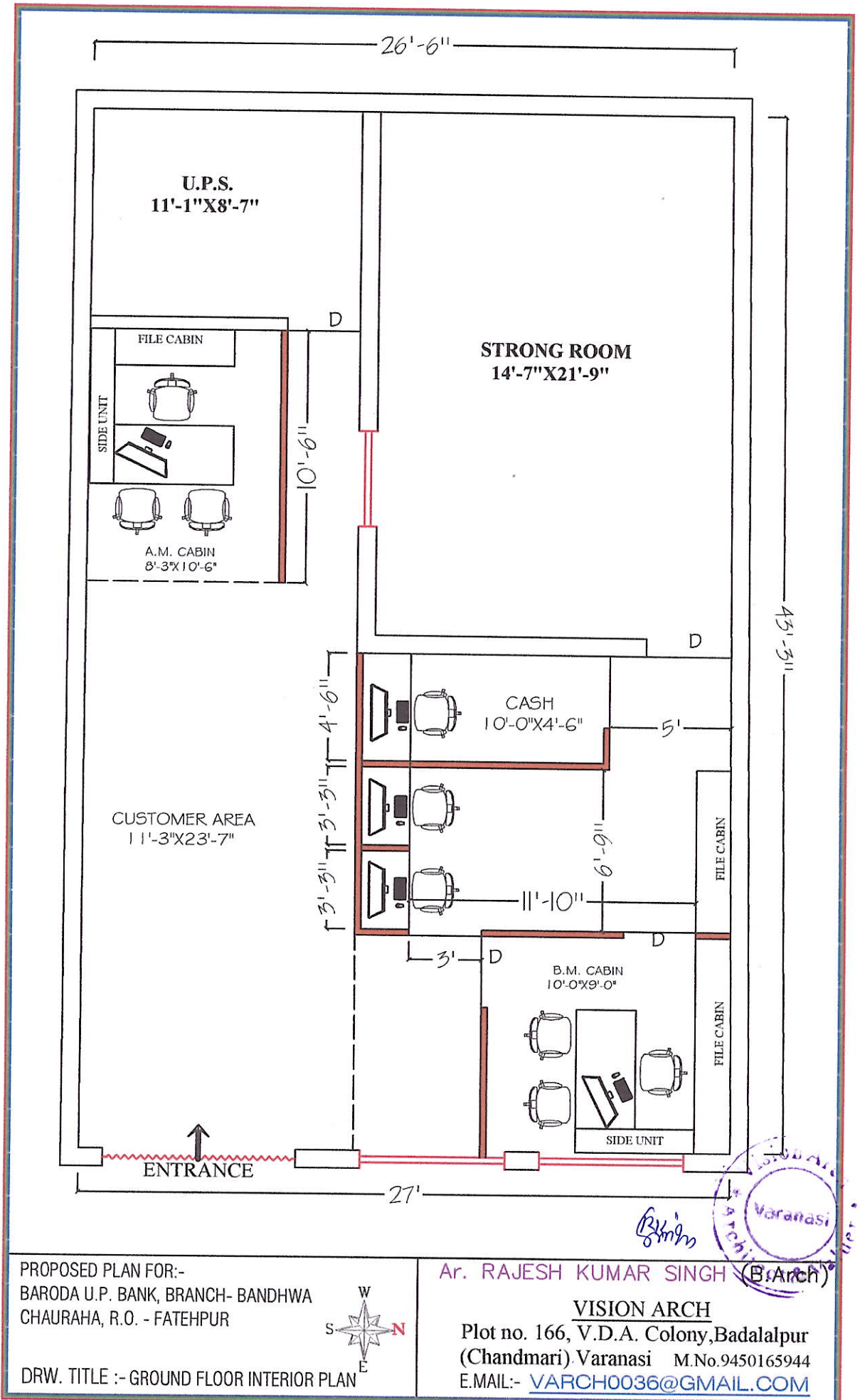

PROPOSED PLAN FOR:-
 BARODA U.P. BANK, BRANCH- BANDHWA
 CHAURAHA, R.O. - FATEHPUR



DRW. TITLE :- GROUND FLOOR INTERIOR PLAN

Ar. RAJESH KUMAR SINGH (B.Arch)

VISION ARCH

Plot no. 166, V.D.A. Colony, Badalapur
 (Chandmari) Varanasi M.No.9450165944
 E.MAIL:- VARCH0036@GMAIL.COM

