



बड़ौदा यू.पी.बैंक
Baroda U.P. Bank

RO/PRAYAGRAJ/04/P&E/2023-24/16

Date:- 26.04.2024

TENDER FOR FURNISHING, ELECTRICAL & DATA WORK OF KARAILA BAG BRANCH, DISTRICT – PRAYAGRAJ.

Baroda UP Bank Regional Office Prayagraj, 3 D Tashkant Marg Civil Line, invites sealed tender for furnishing for our **KARAILA BAG** Branch (Dist- Prayagraj) from the empanelled Furnishers of Baroda UP Bank, Head Office, Buddh Vihar Taramandal Gorakhpur-273016 (U.P).

1. Tender issuing date : 26.04.2024
2. Last date for submission of tender : 15.05.2024 at 04:00 PM
3. Date of opening of tender : 15.05.2024 at 05:00 PM
4. Contact Number : 9793138316
5. Tender to be address to : **The Regional Head**
Baroda UP Bank,
Regional Office- Prayagraj, 3D Tashkant Marg Civil Line,
211001

Terms and condition of tender:

- Ø Rates should be quoted on the space provided in **annexure attached only**. No other sheet/form should be used for quoting rates.
- Ø The competent authority (bank) does not bind themselves to accept the lowest or to give any reasons for its decision of acceptance or rejection of tenders.
- Ø Incomplete in any respect or conditional tender shall liable to be rejected.
- Ø Rates quoted only by bank's empanelled vendors will be consider/accepted.

Other conditions:

- Ø The registration number of the firm along with **GST no.** allotted by the authorities must be submitted.
- Ø **PAN NUMBER** of the firm allotted by the income tax authorities should be submitted (without which the vendor's bid would become invalid and shall be liable to reject)
- Ø Conditional tenders shall not be accepted on any ground and shall be rejected straight.
- Ø Any deviation of the conditions given by the purchaser will not be accepted and bid will be rejected without assigning any reasons.
- Ø If any clarification is required the same should be obtained before submitting the bid.
- Ø The entire document must be signed with the seal and attached as mark of acceptance of terms and condition.

Regional Office : 3 D Tashkant Marg Civil Line Prayagraj 211001 (U.P.)
E-mail: roalla@barodauprrb.co.in; Fax-0532-2407653



बड़ौदा यू.पी.बैंक Baroda U.P. Bank

Ø BUPB reserve the right to accept or reject any bid whole or in parts without assigning any reason thereof.

Ø Bank's decision will be final and no correspondence will be entertained in this regard.

Ø In case of delays in submission/non submission of bids ,Bank will not assume any responsibility.

Ø Bank may reject any or all quotations without assigning any reason.

Tender submission:

Submission of tenders in sealed envelope super scribing "TENDER OF FURNISHING, ELECTRIC, DATA WORK OF KARAILA BAG BRANCH" addressed to "The Regional Manager Baroda UP Bank, Regional Office- Prayagraj, 3D Tashkant Marg Civil Line; 211001", Complete in all respect latest by **05.00 PM dated- 15.05.2024** Tenders received after that shall not be entertained.

Tender must be submitted through hand to hand or through registered post.

Evaluation of tender:

Quoting incredibly low value of items with a view of subverting the tender process shall be rejected straight away.

Yours faithfully,

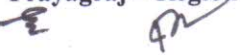
(Santosh Kumar Pandey)
Regional Head
Prayagraj – Region

Ref No.: BA/03/5056/2024

Dated 28-03-2024

**DETAILED ESTIMATE / SPECIFICATION FOR BILL OF QUANTITIES
OF FURNISHING WORK FOR BARODA UP BANK BRANCH AT KARELA BAGH**

Sl.no	Description of items	Unit	Qty.	Rate	Amount
1	False ceiling (Armstrong)	Sft	380		
	Providing and fixing in position false ceiling in Armstrong 600 x 600 mm x 15/16 mm dune supreme RH 99 prima tile with regular edge framework as specified by Armstrong Co. with suspenders wherever required. Maing necessary framework for A.C. ducting if any and necessary cutouts for diffusers and light fittings, taping and finishing to proper line and level including making grooves and trap doors for A.C. unit in 18 mm thick M.R. grade plywood with stainless steel hinges and licks with moulding 1" x 1" for edges including finishing with white plastic emulsion paint etc. complete in all respect. (Note :-only the plan area will be measured for payment no extra payment will be made for cutouts , grooves moulding etc.)				
2	False Ceiling (Gyp Board)	Sft	295		
	P/F Suspended False Ceiling Gyp Board with G.I. Perimeter channels G.I. Intermediate Channels Etc. properly suspended from ceiling with Nylon/G./I. strips sleeves and Screws 12.5 Mm tapered edge Gyp board (confirming To I.S. 2095-1982) ceiling tiles to be screw Fixed to the ceiling section with 25 mm dry Wall screw mechanically at 230 C/C and Finished with jointing compound paper tape and two coars of primer and two coats of plastic paint complete as per design Including perimeter channels required for Light fitting cut out Grill diffusers etc.				
3	PAINTING WORK with Two Coat POP Base (Only Hall Area)	Sft	1500		
	Painting on undecorated / decorated wall and ceiling surfaces with two or more coats of acrylic emulsion (Asian/Berger make) (as / shade approved by the Architect) of approved brand. It shall include for preparing the surfaces clean, even and smooth with thoroughly brushing with broom, scratching with patti and sand papering respectively, so that the surfaces are free from oil, grease, dirt, mortar droppings & other foreign and loose matter. It shall also include for preparing the surface and filling of holes with plaster of paris before priming coat of whiting / approved primer. The rate shall include cost of all materials such as plaster of paris, whiting / primer, glue (Fevicol), indigo / stainer, brushes, sand paper, patti, dhoti, broom stick, clean water with storage and other containers, labour, scaffolding / ladder charges, cleaning of floors and other sundries etc., all complete to the satisfaction of the Architect.				
4	Entrance Door Branch	Sqft	122		

	<p>Providing fabricating & fixing in position twin -style door at Main Entrance made of anodized/powder coated Aluminum sections of size 100mm height x 50mm thick aluminum bottom rail, 100mm x 50mm thick vertical and top rail 100mm x 50mm thick lock rail floor spring of ISI make, clip sections and 12mm thick glass(Modi/ Saint Gobain make) including fixing the frame to brick wall/RCC/wooden surfaces with necessary fasteners to have proper fixity including all incidentals etc complete. Glass to be fixed in the grooves of the aluminum sections with necessary materials/beading etc. The job also includes cost of providing & fixing heavy duty double action hydraulic floor spring (ISI mark) in the floor, fixing the door on it, including necessary fixing materials on the lintel/bottom, bolts, locks & satin finish stainless steel decorative tubular handles(approx.300mm long) on both faces complete as per drawing and instructions. All members to be 16 gauge. The vertical shutter rail to house wool packing to act as a sealant for a gap between shutter and frame fixed glazing. The rate should also include cost for decorative etching on the glass.</p>				
5	Computerised Ledger & Cash Counter				
	<p>Providing and placing in position ledger counter with top, vertical sides/dividers, skirting and fascia made out of 19mm thick water proof board with 1mm thick laminate (as/shade approved by the Architect) on all exposed surfaces. It shall also have 75mm x 40mm teak wood runners below the top and for footrest below. Every unit shall be provided with a side unit (size - W-500mm, H-750mm, D-500mm approx.), consisting of 150 mm deep drawer at top and a cabinet with open able/hinged shutter below.</p>				
	<p>. The fascia of drawer and shutter of cabinet below shall be made out 19mm thick water proof board with 1mm thick laminate (as/shade approved by the Architect) and sides and bottom of drawer shall be made out of 12mm thick water proof ply. The side unit shall have CAM locks, handles, guides, sliding units, hinges, magnetic catcher's etc. of approved make. Every unit shall be provided with a keyboard drawer unit (size - W-550mm, H-100mm, D-300mm approx.) below. The counter shall have 100mm deep fascia, below the top, in which keyboard drawer unit shall be adjusted.</p>				
	<p>It shall be made out 19mm thick water proof board with 1mm thick laminate (as/shade approved by the Architect) and sides and bottom of drawer shall be made out of 12mm thick water proof ply. The unit shall have CAM locks, handles, guides, sliding units etc. of approved make. The job shall include for 6mm x 6mm grooves in between sides and open able drawers and hinged shutters. All the exposed edges of water proof board and ply shall be provided with 6mm thick teak wood/hard wood lipping. All teak wood surfaces shall be melamine polished and other internal surfaces shall be painted with two coats of synthetic enamel over one coat of primer, all complete to the satisfaction of the Architect.</p>				
a	High Level	Rft	5		
	High level (two levels) Computerised cash counter.				
	Lower level top shall be 900mm wide and at 750mm level from floor & upper level top shall be 250mm wide (and at 1150 mm level from				
b	Low Level	Rft	10		
	Low level (two levels) Computerised ledger counter including 1.5 ft High 12 m.m. glass in front of counter with brass clamps The edges of the glass to be machine polished.				

	Lower level top shall be 900mm wide and at 750mm level from floor & upper level top shall be 150mm wide and at 900mm level from floor				
6	Partly glazed partition for cash cabins (Wall side partition not to be done)	Sft	115		
	Decorative Grill (12mm thk)-hexagonal opening as per instruction of Bank's Engineer/Architect.) All exposed edges of Plywood shall be fixed with 1/8" C.P.Teak Lipping.				
	Providing and fixing of Cash Enclosures at height of 7'-4" with Anodized aluminium frame work, heavy sections (2mm thickness) of 2"x1.5", spacing of 2'0"x2'0" on bothsides and covered 6mm thick BWR plywood finished with 1mm thick laminate of blue, red colours for skirting & borders.Partition shall have provision for opening and 19mm BWR plywood tray for challan receiving purpose. Cost include aluminium grill and fixed with teak wood beading and duco paint. Cost also include 3 Nos of Solid core flush Doors with sizes of 2'6"x7'0", fixed in the partition. Door shall have teak wood beading and lipping with duco paint. Door finished with 1mm thick laminate of white colour for base and red & blue for skirting of approved pattern. Door shall have 8mm glass fixed with teak wood beading and duco paint. Rate to include hardware's like brass hinges, godrej three nos of night latch, door closure, door stopper and handles. Cost also include cash transaction opening shall be provided with door arrangements made with BWR plywood frame work finished by laminate. duco paint and locking system. Cost include wastages, transports, loading, unloading charges, labours, materials, tools, lead, lift and etc.Complete as per drawings and instructions of the Architect.				
	Solid till 4'-0" then Aluminium Decorative Grill height till 7'-0"then again solid				
7A	FULL HEIGHT GLAZED & UNGLAZED PARTITION (HT -8'-6")	0.00	Sq.Ft		
	Glazed Partition(upto false ceiling height only considered and above necessary ceiling supports to be provided) with Anodized Aluminium frame work, heavy sections (2mm thickness) of 2"x1.5" section, spacing of 2'0"x2'0" on bothsides and covered with 9mm thick BWR plywood finished with 1mm thick laminate of skirting & borders on both sides.Above 1'0"/2'6"/3'0" height partition, fixed with 8.0 mm bevelled glass with 3m sticker works door and teak wood beading with duco paint. Clear glass shall be finished with frosted film sucking over the glass of approved pattern and design. Rate to include providing cutouts and provisions to run electrical conduits, switches, etc..Cost include wastages, transports, loading, unloading charges, labours, materials, tools, lead, lift and etc.Complete as per drawings and instructions of the Architect.				
	The job shall also include for provision of laying conduits, switch boxes etc. The erection of partition shall include for expansion bolts cleats, clamps bolts, nuts, screws, rivets and other accessories, all complete up to the satisfaction of the Architect.				
	All door opening shall have rebated teak wood framework (size - 75mm x 50mm, as per profile) on vertical (2 Nos.) and horizontal (1 No.) sides, with melamine finish and rebate of 40mm x 12mm, all complete up to the satisfaction of the Architect.				
	the partition and doors shall have hinges floor springs/sliding arrangement/hydraulic door closer, mortise locks (Godrej make all), etc. The rate shall include cost of all materials, labour, T&P, wastages, etc. required for proper completion of work, all complete to the satisfaction of the Architect.				
B	Partly glazed low height partition	Sft	115		

	Same specification as in 1 but P/F half height partition of height 4'-6" with wooden laminate till 3'-0" and 1'-6" height 12 mm thick glass secured with D brackets including all hardware necessary with the same specs.as above.				
8	Providing and fixing Column & wall Panelling consisting of 2" x1 " 18 gauge section placed at 2'0x2'-0" horizontally and vertically with Unannodised Allumnium size 1.5mm thick of JINDAL/ INDAL confirming to ISI 303 standard as internal frame structure (as per site requirement) framework. The framing shall be fixed with with 8mm thick MR grade ply + 6 mm MDF of approved make firmly screwd to the aluminium frame on either side finished with 1mm th (high glossor texture) laminate as per approved sample. Item includes providing and fixing 12x12mm steem beech wood beading	Sft	295		
	making 6 mm grooves complete with polish & melamine spray finish on wood surface/grooves as per architectural drawings finished with 1mm thick laminate. Item includes providing and fixing 100mm wide skirting of 1mm thick mettalic laminate as per approved sample. Note: Surface measurement for one face & visible areas below false ceiling will be made for payment.				
9	Manager's table + Side Table with 12mm thk glass top	Each	1		
	Providing and fixing in position manager's table of size 6'-0"x2'6" as per drawing no. including side storage (credenza)by using 25 mm thick plywood for top and 18 mm thick plywood for all other horizontal and vertical members. Telescopic CPU stand/ready made keyboard tray shall be provided of approved model and make. Footrest made with TW member of size 4"x1 ½ " finished with french polish.as per.				
	drawing shall be provided. Facia of side storage(credenza) shall be finished with 1 mm thick laminates as shown in the drawing and all other sides shall be finished with white enamel paint. The side storage (credenza) shall be provided with handles (stainless steel finish) and channels as per approval of the project consultant/bank . all exposed plywood surfaces to be finished with 1 mm thick . laminates of approved make and shade and all exposed edges of table top and ply verticals to have 1" x ¼" TW lipping , all exposed TW section to be melamining and internal surfaces to have white enamel paint as directed. Item ti include plywood boxing , all necessary hardware and fittings in stainless steel finish , lipping to all edgs etc. complete in all respect.				
10	Officer table + Side Table with 12mm thk glass top 5'-0"x2'-6")+Side table	Each	0		
	Same specification as above				
11	Full height storage / low height storage/ back storage (credenza)	Sft	60		
	Providing and fixing in position full height storage / low height storage / back storage (credenza) as shown in drawing no. (8) (9) and (10) respectively using plywood of required thickness finished with 1 mm thick laminates as shown in the drawing and all other sides shall be finished with white enamel paint as detailed therein.				
	The storage units shall be provided with handles (stainless steel finish) as per approval of the project consultant/bank.				

	All exposed plywood surfaces to be finished with 1 mm thick. Laminate of approved make and shade and all exposed edges of plywood to have 1"x1/4" TW lipping . all exposed TW section to be melaminated in matching colour laminate and internal surfaces to have white enamel paint as directed . item to include all necessary hardware an fittings in stainless steel finish ., Godrej multi purpose locks including magnetic ball catcher etc. complete in all respect.				
12	12 MM THICK GLASS FOR CASH CABIN				
	Providing & fixing 12 m.m. glass in front of cash cabin with brass clamps including cut out for passing currency as/details.The edges of the glass to be machine polished.	Sq. ft.	32		
13	Suggestion box	No	1		
14	Public writing wall stand (including cost of fitting) 36"x16"x9" 19mm Board, 1.00 mm thick mica, teak wood beeding, Polish/Paint with fitting.	No	1		
15	Check drop box	No.	1		
16	A.C.P Panelling of entrance	Sft	130		
	Providing and fixing in position aluminium composite panel boxing with PVDF coating and LDPE core laminate eurobond / altobond / composite of (0.5 mm-33-0.5mm) including fabrication for the same with aluminium sections required hardware, silicon sealent (dow corining 789) masking tape necessary scaffolding etc. complete in all respect				
Total					0.00

Sl. No.	Materials	Approved manufacturers / suppliers
1	Paint	I.C.I. (Dulex - Duco) / Asian paints / Goodlac Nerolac
2	Plywood	BWR- Century/Green/Archid only Premium quality
3	Wood preservative	BWR- Century/Green /Archid only Premium quality
4	False ceiling	Armstrong , Indian gypsum board
5	Laminates	Sunmica/ Archid/Century/Green 1mm thick as per bank approved color
6	Screws	G.K.W./Nettle fold
7	Adhesive	Fevicol SH
8	Night latch	Godrej
9	Locks	Godrej
10	Aluminium door frame	Jindal
11	Glass	Modi/Asahi/Saint Gobain
12	Aluminium cladding	Eurobond/Altobond/Alukbond
13	Key board drawer	EBCO
14	Telescopic CPU stand	EBCO
15	Cable organiser (wire manager)	EBCO
16	Vitrified tiles	Jhonsions Perlto
17	Venetion blind	Vista, Luxaflex

Note : Plywood mentioned in the drawings as well as in bill of quantities should be IS: 710 BWR- Century/Green only Premium quality.

Ref No.: BA/03/5056/2024

Dated 02-04-2024

DETAILED ESTIMATE / SPECIFICATION FOR BILL OF QUANTITIES
OF ELECTRICAL WORK FOR BARODA UP BANK BRANCH AT KARAILA BAG

Sl.no	Description of items	Unit	Qty.	Rate	Amount
1	Supply & Installation of concealed point wiring using 600v grade 3x1.5 Sq.mm copper conductor PVC insulated wires (with proper R,Y,B color code) pulled through heavy gauge 19mm PVC conduit pipe heavy duty concealed in wall/ floor/ panelling/ partitions or above false ceiling as per requirement including 2 Nos. 2.5 sqmm circuit wires from the relevant DB and also including 1.5 sqmm green color copper earth wire and switch plate, switches, etc. as approved by the Bank's Engineer/Architect. All switch & sokets shall be modular type complete with cover plate & GI/ MS box. The work shall also include for cutting chase for conduits and moulded boxes, if required, in the wall/ floor (Without damaging the building/wall) along with clamping the conduit at every 600mm interval & finally finishing the surface & matching the same with the existing surface.The rate should include the cost of all materials, labour, T&P, taxes & levies, scaffolding, shifting of furniture, carting away the debris and cleaning the floor etc.The job shall be complete & to the entire satisfaction of the Bank.				
a	Light points + AFF points including the cost of 6A switch	Point	45		
b	Ceiling Fan Point including the cost of 6A Switch along with electronic regulator	Point	2		
c	Wall Fan Point along with 6A switch	Point	8		
d	6A switch & Socket on SDb	Point	5		
2	RAW POWER POINT				
	Single Power Points - Supply & Installation of point wiring for Raw power plug points on workstations / table for computers using 2 X2.5 + 1x1.5 Sq.mm copper conductor PVC sheathed flexible wire pulled through heavy gauge 19mm PVC conduit pipe heavy duty concealed in wall/ floor/ panelling/ partitions or above false ceiling as per requirement. Each point consisting of 1 nos of 16A , 2/3/5 pin sockets & 1 No.16A Switch wired together forming one point. The earth wire of green color only. All switch & sokets shall be modular type complete with cover plate & GI/ MS box. The work shall also include for cutting chase for conduits and moulded boxes, if required, in the wall/ floor (Without damaging the building/wall) along with clamping the conduit at every 600mm interval & finally finishing the surface & matching the same with the existing surface.The rate should include the cost of all materials, labour, T&P, taxes & levies, scaffolding, shifting of furniture, carting away the debris and cleaning the floor etc.The job shall be complete & to the entire satisfaction of the Bank.	Point	5		
3	AIR CONDITIONING				

a	AIR CONDITION POINTS - Circuit wiring with 2x4.0sq.mm + 1x 1.5sq.mm stranded Cu. conductor (Finolex/Anchor/Skytone) in 19mm M S conduit pipe heavy duty 16swg laid & concealed in wall/ floor/ panelling/ partitions or above false ceiling as per requirement. The job includes supply & fixing of flush mounted 4in one appliance protector pre-wired, IP 20 with factory fitted 25A, 2P MCB and 25A socket (Hagers/ Siemens/ ABB). The rate should include the cost of all materials, labour, T&P, taxes & levies, scaffolding, shifting of furniture, carting away the debris and cleaning the floor etc.The job shall be complete & to the entire satisfaction of the Bank.	Point	3		
4	UPS				
A	Sub Main Wiring/ Cabling - : SITC of sub main wiring 4nos. 10 sq.mm Stranded copper wires for UPS Input from main incoming panel to incoming Db of UPS power input system etc. in 25mm dia PVC haevy duty conduit complete to the satisfaction of the bank.	JOB	1		
B	UPS Power Input System: SITC of 4way TPN Double door Db IP 42 horizontal Complete with 1no. Incoming 32A. TP MCB and 3 x 32A 2P MCB's to regulate supply for UPS complete in all respect as required and to the satisfaction of the bank.	Set	1		
C	Wiring for UPS Input & UPS Output (For both Critical 2Kva & Non- Critical 3Kva UPS) with 2x4.0sq.mm + 1x 1.5sq.mm stranded Cu. conductor (Finolex /Anchor /Skytone) to be laid in 19mm PVC pipe heavy duty/ Flexible pipe laid & concealed in wall/ floor/ panelling/ partitions or above false ceiling as per requirement. The rate should include the cost of all materials, labour, T&P, taxes & levies, scaffolding, shifting of furniture, carting away the debris and cleaning the floor etc.The job shall be complete & to the entire satisfaction of the Bank.	JOB	1		
D	S/F of 32A 2P MCB in 2way metallic box including proper connectionbs thru lugs. Both the Db's shall be inter looped- Qty included in item 3. (2nos. For ATM and 2nos. For Branch)	Each	1		
E	UPS Output Power Distribution System: SITC of 12 way SPN Db Double door IP -43 Siemens make with 32A DP 10kA MCB and 09 nos. SP 10kA MCB complete in all respect and as required & to the satisfaction of the bank. Siemens/ L&T/ MDS/ Schnider	Set	1		
F	Input Wiring for UPS Db's with 2x4.0sq.mm + 1x 1.5sq.mm stranded Cu. conductor (Finolex /Anchor /Skytone) to be laid in 19mm PVC pipe heavy duty/ Flexible pipe laid & concealed in wall/ floor/ panelling/ partitions or above false ceiling as per requirement. The rate should include the cost of all materials, labour, T&P, taxes & levies, scaffolding, shifting of furniture, carting away the debris and cleaning the floor etc.The job shall	JOB	1		
G	Supply & fixing of 4nos. 6A switches & sockets (Modular type c/w MS/GI box & cover plate) complete with computer point circuit wiring with 2x2.5sq.mm + 1x 1sq.mm stranded Cu. Single core Copper conductor (Finolex/Anchor/RPG) to be laid in PVC conduit 1" dia/ vertical drops heavy duty laid & concealed in wall/ floor/ panelling/ partitions or above false ceiling as per requirement.	Per Node	5		
5	MAIN INCOMING PANEL & DISTRIBUTION				
A	SITC of 100A Kit kats fuse unit 3nos in wooden patra complete with 100Amp. Neutral link complete in all respect as required.	Set	1		
	1 No for Metre				
	1 no for Panel to Outer Side Of Wall (For Generator Connection)				

B	Main Incoming Panel				
	Supply, Installation, Testing & Commissioning of main distribution board panel fabricated of 18swg (powder coated) comprising of	Nos.	1		
	Indicator lamps 3 nos.				
	Voltmeter & ammeter(one each)				
	Rotary selector switches 2 nos for voltmeter & ammeter				
	Busbar (each of RYB +N) copper 100 amp each				
	125 Amp MCCB(Siemens/ L&T/ ABB/ Schnider) incoming 3P adjustable 25kA				
	Changeover TPN 100 amp for DG set (Havells/ ABB/ Sochomac)				
	Outgoing 63A 3P MCB's - 6 nos.				
	Outgoing 32Amp 2P MCB's - 6 nos.				
	Earth bus bar 25x5mm GI strip - 2nos. At the bottom.				
6	Supply Installation testing & commissioning of XLPE insulated Armoured Al.codutctor cable between main panel & DB's & generator of required thickness of approved make Skytone/ Havells based on the load assessment & confirmation of the same with architect. This rates include cost of lugs at both the ends				
	3.5 x50 sq.mm cable from Meter to Kit kat to the main panel & Pole (Approx - 20 mtr)	JOB	1		
	4c x20 sq.mm cable from Main Panel TO LHS DB (Aprrox - 20 mtr)	JOB	1		
	4c x 20 sq.mm cable from Main Panel to RHS DB (Aprrox - 20 mtr)	JOB	1		
	4c x 20 sq.mm cable from Main Panel to Kikat (Generator) (Approx - 40 mtr)	JOB	1		
7	Supply, installtion, testing & commissioning of VTPN Db double door with MCB as incomer IP 42 complete in all respects for AC, PP and L & F as under - Siemens/ Hager/ Lagrand/ ABB				
A	RHS 6way VTPN db - Loaction RHS wall opposite Cash cabins (From entrance to Rear record room & Toilet area) - Siemens				
	Incomer - 63A 3P MCB 10kA adjustable neutral to be directly connected to neutral bus	Each	1		
	3no. 32A 1P-MCBs 10 KA - AC's - 2nos. RHS & 1rear				
	3no. 16A 1P-MCBs 10 KA - for single power points - 2 cash & 1 May I help You & 2nos. D/W				
	4nos. 10A 1P-MCBs 10 KA for L&F				
	4os. 6A 1P-MCBs 10 KA for L&F				
	Blanking Plates - 2no.				
	All connections to be terminated thru lugs				
B	LHS 6way VTPN db - Loaction LHS wall behidn advance (From LHS LV Cash to Mgr Rm)- Siemens 8GB0406VRC or equivalent				
	Incomer - 63A 3P MCB 10kA adjustable neutral to be directly connected to neutral bus	Each	1		
	4o. 32A 1P-MCBs 10 KA - AC's - 3nos. LHS & 1 Mgr Rm				
	4no. 16A 1P-MCBs 10 KA - for single power points - (LV cash, 2 CRE, 1Advance, 2 MR & 2 Router)				
	2nos. 10A 1P-MCBs 10 KA for L&F				
	2os. 6A 1P-MCBs 10 KA for L&F				
	Blanking Plates - 2no.				
	All connections to be terminated thru lugs				

8	Glow sign Board - Circuit wiring with 2x2.5sq.mm + 1x 1.0sq.mm stranded Cu. conductor (Finolex/Anchor/Skytone) to be laid in 19 mm PVC pipe heavy duty laid & concealed in wall/ floor/ panelling/ partitions or above false ceiling as per requirement. The rates should include the cost of all materials, labour, T&P, taxes & levies, scaffolding, shifting of furniture, carting away the debris and cleaning the floor etc.The job shall be complete & to the entire satisfaction of the Bank.	JOB	1		
	<u>E -EARTHING</u>				
9	For Main Panel - S/burying of Dual pipe technology (Pipe in Pipe) earthing electrode having GI 80mm O/D pipe with 25 micron coating, 3metres long. The space between two pipes to be filled with Highly conductive & Non corrosive chemical compound. The installation shall be thru earth auger. The vacant space between pipe & hole shall also be filled with compound all around. The job also includes S/F of GI strip clamp with two holes (with SS/GI bolts & nuts) on the electrode & taking two earthing leads of 25 x 5 mm GI strip (Assumed length of 10m - beyond 10m to be paid extra) upto Main panel complete in all respects with guaranteed E/N voltage of less than 3 volts and resistance less than 1 ohms. The distance between two earthing pits to be 10ft or more INCLUDING Earth wire 4 sq mm copper wire . Approx -80 mtr (2 FOR BRANCH &	Per Icn.	2		
10	<u>F - FIXTURES & FITTINGS</u>				
A	a) Supplying and fixing Philips make 36W LED FLAT PANEL after disconnection of existing fitting 2'x2' size in grid type false ceiling, 600x600 suitable for recess mounting,CRCA sheet, asthetic looking, or eqv Philips/havells	Each	8		
B	b) Supplying and fixing Philips make or eqv 10 W LED round type downlighter (Philips/ wipro /Jaguar)	Each	18		
C	Supply installation testing and commissioning of 1*20watt Batten type tubular LED light fitting with LEDs, driver, diffuser, and housing complete in all respects in UPS room and record /wc/bath room /suitable place with complete in all respect with required color on need basis.	Each	8		
D	S/F of angle holder for bulbs including cost of 11w CFL lamp for Toilets	Each	4		
E	i) Supply & installation of wall bracket fan 450 MM (Heavy duty/ high speed) Make Bajaj/crompton greaves/havells/Orient (to be supplied after consultation with architect/Electrical Engineer as per approved drawing)	Each	8		
F	g) Supply & fixing of the 1200 mm 48") Sweep Ceiling fan (Orient PSPO/crompton greaves/havells) with downward rod(below false ceiling), canopy etc. including of PVC flexible copper wire.(white colour)(High speed) (Warranty Cerificate is necessary)with downward rod, circular boxes, ball sockets, ceiling plates,suitable arm bracket etc. including connection with wire)White colour (WITH REGULATOR)	Each	2		
G	Supply & Fixing of fresh air fan 12" - Crompton Greaves/ Usha/ Khaitan/ Bajaj	Each	3		
H	e) Supplying and fixing LED strip 3000 K 24 watt 5 mtr length with driver (Philips or Havells or Cormpton)	SET	0		
11	<u>H - TELEPHONE</u>				

A	P/f Krone or equivalent box in the server room & out side of the Branch with a ten pair connecting strip for telephone with lock & key	Each	0		
B	10 Pair Cable with Connection from main Panel to entrance of the Branch	JOB	0		
C	Supply & fixing on wall/ furniture/ partition recessed type non modular telephone socket outlet (RJ-11) with mounting box & front plate complete with chase cutting, mending good etc. as required complete with Supply & laying of 2pair 0.61mm dia. PVC insulated telephone cables through 19mm dia rigid PVC conduit of suitable diameter as directed by the consultant from telephone junction box to telephone socket outlet including interconnection mending good etc. as required complete in all	Each	0		
D	Wireless Call Bell of Approved Quality (Orient,Sunshine)	No.	0		
12	I - DATA CABLING				
A	Supply & Fixing of XL RJ 45 toolless information outlet with Duplex face plate with dual connectors Grey colour cat 6e including cost of supplying & laying CAT 6e (as directed by Architect from Server to Switch, Switch to computer I/O data socket as required complete in all respects) in 25mm dia rigid PVC conduit (including laying of GI draw wire complete with junction box, circular box, elbows, bends & other accessories as required by chase cutting on floor, wall, through partition or over false ceiling.The data cabling pipe should be laid at a minimum distance of 3ft from pipes laid down for power distribution) including interconnection with connectors as required complete in all respects.	Each	7		
B	Supply & fixing of 7ft Grey colour Patch chord Giga speed Systimax/ D link make	Each	7		
C	Supply & fixing of 3ft Grey colour Patch chord Giga speed Systimax/ D link make	Each	7		
D	S/F of 24Port Jack Panel fully loaded systimex make	Each	1		
E	S/F of 9 U wall mounted rack c/w fan etc as required	Each	1		
F	S/F of Cable Manager as required	Each	1		
		Total			
Sl. No.	Materials	Approved manufacturers / suppliers			
18	MCCB	MDS legrands, ABB, GE, SIEMENS			
19	Changeover	Indo Asian/ HPL Socomec / GE/ Standard stangaurd			
20	Distribution board	MDS / Standard / Indo Asian / HPL			
21	MCB	MDS / Standard / Indo Asian / HPL			
22	Cable	Gloster / Rallison / Incab / CCI			
23	Copper wire	Finolex/anchor			
24	Switch / Socket / Call bell and accessories	Anchor / Havells / CPL / MDS / Philips			
25	Electrical Light Fittings / Fixtures Complete	Philips			
26	Wall Fan / Ceiling Fan / Exhaust Fan	Khaitan/Havells			

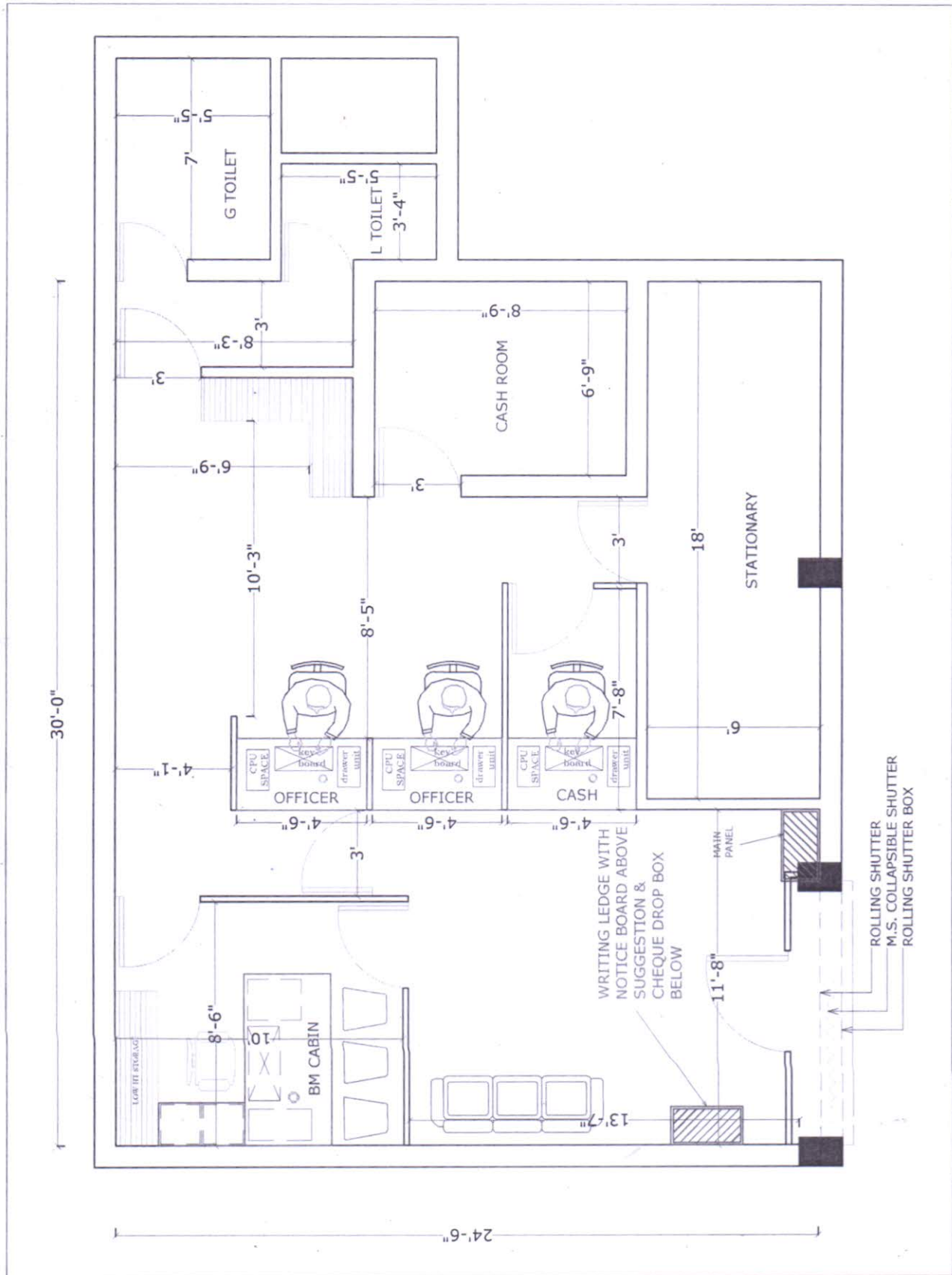

BHARAT & ASSOCIATES
 5, Tagore Town Bhojubar varanasi
 Ph.0542-2505982 M. 9415221355

Option: I
 Drawn By

Proj. Title
 FURNISHING PLAN
 Date
 29.01.2024

JOB TITLE
 PROPOSED LAYOUT PLAN FOR
 BARODA UP BANK KARELA BAGH